

**IN THE UNITED STATES DISTRICT COURT
FOR THE DISTRICT OF NEW MEXICO**

UNITED STATES OF AMERICA, for Itself
and as Trustee for the Zuni Indian Tribe, Navajo
Nation and Ramah Band of Navajos
and
STATE OF NEW MEXICO, ex rel. STATE
ENGINEER,

Plaintiffs,

and

ZUNI INDIAN TRIBE,
NAVAJO NATION,

Plaintiffs in Intervention,

v.

STATE OF NEW MEXICO COMMISSIONER
OF PUBLIC LANDS,
and
A & R PRODUCTIONS, et al.,

Defendants.

No. 01cv00072-MV/WPL

**ZUNI RIVER BASIN
ADJUDICATION**

Sub-areas 9 and 10

CONSENT ORDER

The Court, having considered the agreement between the Plaintiffs, the United States of America ("United States") and the State of New Mexico ex rel. State Engineer ("State"), and:

C.L. MONTANO & BEA MONTANO

("Defendant") concerning the Defendant's right(s) to use the public waters of the Zuni River Stream System, Sub-areas 9 and 10, as set forth below FINDS:

1. The Court has jurisdiction over the United States, the State, the Defendant and the subject matter of this suit.

2. As evidenced by the parties' signatures below, the United States, the State, and the Defendant are in agreement concerning all elements of the right(s) of the Defendant set forth in paragraph 4 of this Consent Order to divert and use the public waters of the Zuni River Stream System, Sub-areas 9 and 10. This Consent Order and the parties' respective signatures below evidence the entire agreement between the United States, the State, and the Defendant regarding the elements of the water right(s) adjudicated by this Consent Order.

3. There is no just reason to delay entry of this Consent Order as a final judgment as between the United States, the State, and the Defendant regarding the elements of the claims of the Defendant adjudicated by this Consent Order.

4. The right(s) of the Defendant to divert and use the public waters of the Zuni River Stream System, Sub-areas 9 and 10, is as set forth below:

WELL

Map Label: 10B-4-W13

OSE File No: None

Priority Date: 12/31/1983

Purpose of Use: NON 72-12-1 DOMESTIC & LIVESTOCK

Well Location: As shown on Hydrographic Survey Map 10B-4

S. 30 T. 06N R. 17W 1/4, 1/16, 1/64 SE SW SW

X (ft): 2,471,898 Y (ft): 1,351,493

New Mexico State Plane Coordinate System, West Zone, NAD 1983

Amount of Water: 0.722 ac-ft per annum

5. Defendant has no right to divert and use the public waters of the Zuni River Stream System, Sub-areas 9 and 10, except as set forth in this Consent Order and other orders entered by this Court in this cause.

6. The Defendant, and Defendant's successors, representatives, heirs and assigns, should be enjoined from any diversion or use of the public waters of the Zuni River Stream System, Sub-areas 9 and 10, except in strict accordance with this Consent Order and other orders of the Court in this cause.

7. The water right(s) described herein, if any, are adjudicated as between the United States, the State, and the Defendant, subject to the right of any other water right claimant with standing to object prior to the entry of a final decree.

IT IS THEREFORE ORDERED that the right(s) of the Defendant to divert and use the public waters of the Zuni River Stream System, Sub-areas 9 and 10, are adjudicated as set forth herein, as between the United States, the State, and the Defendant. The Defendant, and Defendant's successors, representatives, heirs and assigns, are hereby enjoined from any diversion or use of the public waters of the Zuni River Stream System, Sub-areas 9 and 10, except in strict accordance with this Consent Order and other orders of this Court in this cause. The Court enters this Consent Order as a partial final judgment, binding on the United States, the State, and the Defendant as to the elements of Defendant's water right(s) set forth herein, subject to the right of any other water right claimant with standing to object prior to the entry of a final decree, and subject to the terms of the final decree in this proceeding

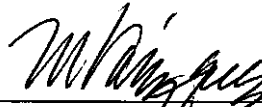

MARTHA VALQUEZ
UNITED STATES DISTRICT JUDGE

Approved:



WILLIAM P. LYNCH
UNITED STATES MAGISTRATE JUDGE

ACCEPTED:

C. L. MONTANO

DATE

DEA MONTANO

DATE

C. L. Montano 9-6-16
Dea Montano 9-6-16

ADDRESS:

COUNSEL FOR THE DEFENDANT (IF REPRESENTED):

DATE

COUNSEL FOR THE UNITED STATES:

DATE

ANDREW "GUSS" GUARINO

U.S. Department of Justice
South Terrace, Suite 370
999 18th Street
Denver, CO 80202
(303) 844-1343

[Signature]
3/21/16

COUNSEL FOR THE STATE OF NEW MEXICO *EX REL* STATE ENGINEER:

DATE

EDWARD C. BAGLEY

Special Assistant Attorney General
Office of the State Engineer
P.O. Box 25102
Santa Fe, NM 87504
(505) 827-6150

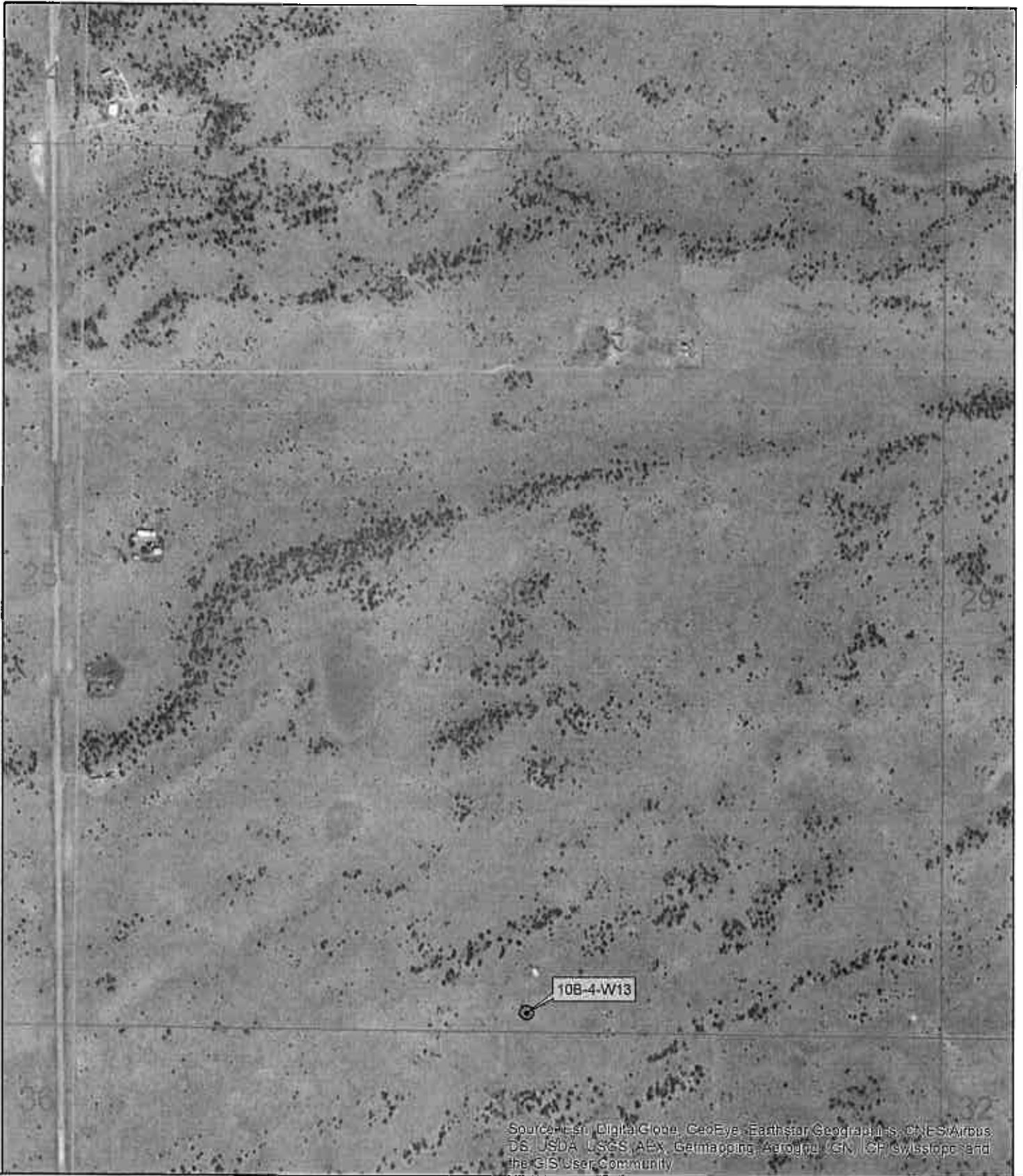

[Signature]
3/21/2016



Source: Esri, DigitalGlobe, GeoEye, Earthstar Geographics, CNES/Airbus, DS, USDA, USGS, AeroGRID, IGN, IGP, Swisstopo, and the GIS User Community

June 2015

LEGEND

-  Well
-  Sub-Area Boundary
-  Section Boundary



1 inch = 800 feet

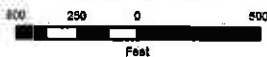

Zuni River Basin
Hydrographic Survey

Sub-Area 10
Subfile Number: ZRB-2-0125
PLSS: S30, T06N, R17W
Sheet 1 of 1



Natural Resources Consulting Engineers, Inc.

Fort Collins, CO Oakland, CA Asmara, ERITREA